

5/16" BORE STAINLESS STEEL CYLINDER



SSR-05-□-□

Single Acting

Mount: Stud **Standard Stroke Lengths:** 1/2", 1", 1-1/2", 2", 3", 4"
Type: Rotating Rod **Spring Compressed:** 1 lbs. **Spring At Rest:** 0.5 lbs.
Options: B, V, N, S **Maximum Stroke:** 29" For B option add 0.250
 For S option add 0.220

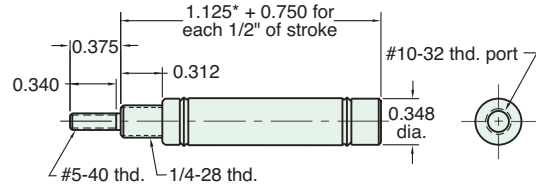

Nut included, but not shown on drawing

USR-05-□-□

Single Acting

Mount: Universal **Standard Stroke Lengths:** 1/2", 1", 1-1/2", 2", 3", 4"
Type: Rotating Rod **Spring Compressed:** 1 lbs. **Spring At Rest:** 0.5 lbs.
Options: B, V, N, P6 **Maximum Stroke:** 29" For B option add 0.250

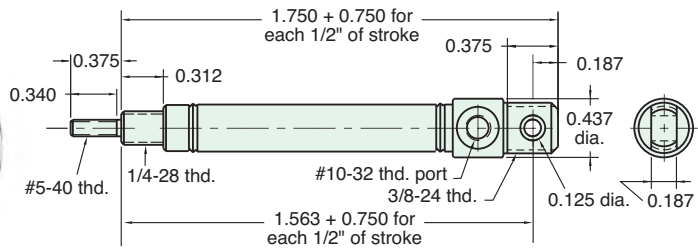

Nuts included, but not shown on drawing

SDR-05-□-□

Double Acting

Mount: Stud **Standard Stroke Lengths:** 1/2", 1", 1-1/2", 2", 3", 4"
Type: Rotating Rod **Maximum Stroke:** 43"
Options: B, V, N, S, P6, P7, P8 For B option add 0.250
 For S option add 0.220

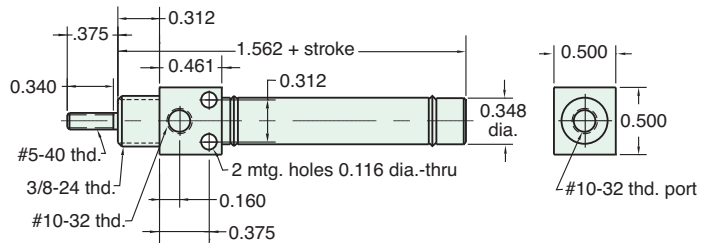

Nut included, but not shown on drawing

UDR-05-□-□

Double Acting

Mount: Universal **Standard Stroke Lengths:** 1/2", 1", 1-1/2", 2", 3", 4"
Type: Rotating Rod **Maximum Stroke:** 43"
Options: B, V, N, P2, P3, P4, P5, P6, P7, P8 For B option add 0.250

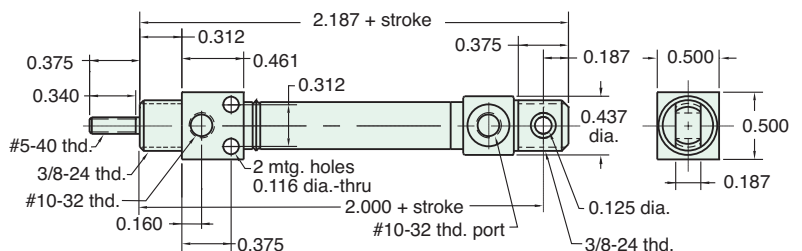

Nuts included, but not shown on drawing