

5/8" BORE STAINLESS STEEL CYLINDER



SDD-10-□-□

Double Acting

Mount: Stud **Standard Stroke Lengths:** 1/2", 1", 1-1/2", 2", 3", 4"
Type: Double Rod **Maximum Stroke:** 20"
Options: M, B, W, V, N, P6, P7, P8 For B option add 0.500
 For M option add 0.312

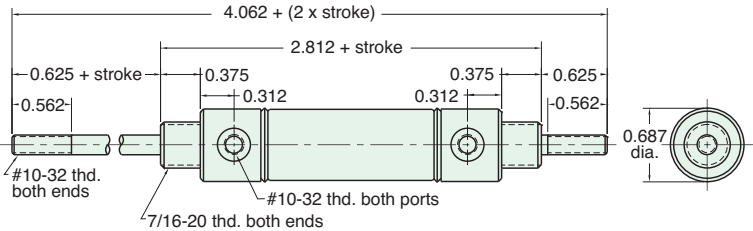

Nuts included, but not shown on drawing

SRR-10-□-□

Reverse Acting

Mount: Stud **Standard Stroke Lengths:** 1/2", 1", 1-1/2", 2", 3", 4"
Type: Rotating Rod **Spring Compressed:** 4 lbs. **Spring At Rest:** 1.3 lbs.
Options: M, B, W, V, N, H **Maximum Stroke:** 15"
 For B option add 0.500
 For M option add 0.312

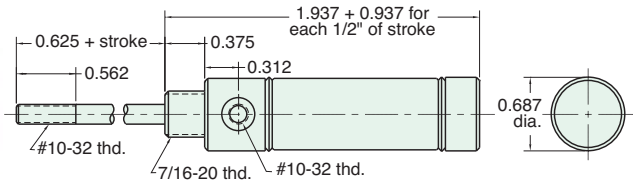

Nut included, but not shown on drawing

URR-10-□-□

Reverse Acting

Mount: Universal **Standard Stroke Lengths:** 1/2", 1", 1-1/2", 2", 3", 4"
Type: Rotating Rod **Spring Compressed:** 4 lbs. **Spring At Rest:** 1.3 lbs.
Options: M, B, W, V, N, H, P2 **Maximum Stroke:** 14"
 For B option add 0.375
 For M option add 0.312

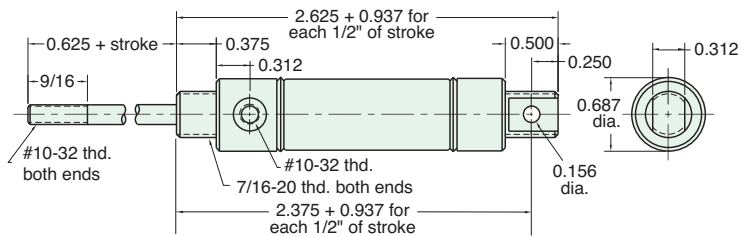

Furnished without nut(s). See Chart on Page 23.

For harsh environments, refer to [page 72](#) for Clippard's Corrosion-Resistant Stainless Steel 5/8" cylinders.

