



# 3/8" BORE BRASS MINIMATIC® CYLINDER

## 3SS-AR-1/2

**Mount:** Stud  
**Type:** Single Acting  
 Spring Extended

**Available Stroke Lengths:** 1/2"

Add **-N** to the end of the part number for a non-threaded rod

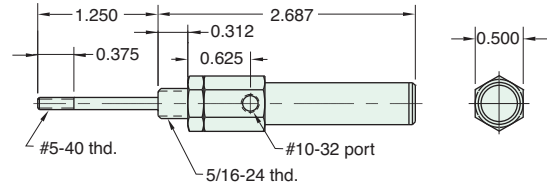

Rod nut included, but not shown on drawing

## 3PS-1/2

**Mount:** Body  
**Type:** Single Acting  
 Spring Return

**Available Stroke Lengths:** 1/2"

**Ports:** End or Side

Brass Rod - non-rotating

First Cylinder - 1949

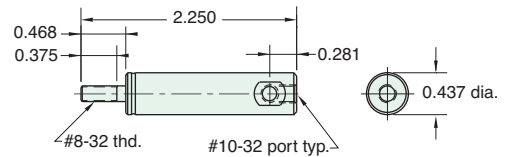

Rod nut included, but not shown on drawing

## 3SS-□

**Mount:** Stud  
**Type:** Single Acting  
 Spring Return

Stroke Length "L"	1/2"	1"	2"	3"
	2.093	3.343	5.218	7.093

**To order:** Add stroke length to the end of the part number

Add **-T** to the end of the part number after stroke for a #10-32 x 1/2" rod thread

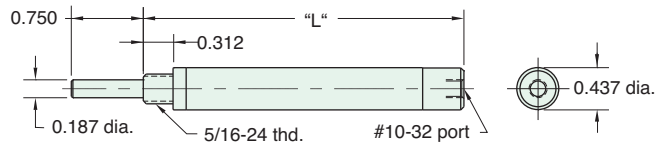

## 3CS-□

**Mount:** Clevis  
**Type:** Single Acting  
 Spring Return

Stroke Length "L"	1/2"	1"	2"	3"
	2.468	3.406	5.281	7.156

**To order:** Add stroke length to the end of the part number

Add **-T** to the end of the part number after stroke for a #10-32 x 1/2" rod thread

